

SPECIFICATIONS

MODEL NUMBER	SD-10
COLOUR MEASUREMENT	
Technology	Spectroscopic Device
Spectral Range	400 – 700nm
Sampling Interval	Colour Measurement
Photometric Range	10 nm (Interpolation by software)
Measurement Frequency	13 times measurement per second (Scanning Mode)
Measurement Geometry	45° Circumferential / Normal Geometry (45° c : 0°)
Measurement Aperture	Φ 7.6mm
Light Source	LED (Including UV)
Measurement Conditions	<ul style="list-style-type: none"> M0: Including UV light component, ISO 13655:2017 measurement condition M0 M1e: D50 - Including UV light component, measurement conditions equivalent to ISO 13655:2017 measurement condition M1 (Measurement conditions held with a radiant power at all wavelengths from 400 to 700 nm, and power ratios in the 300 to 400 nm and 400 to 500 nm regions similar to D50) M2: Without UV, ISO 13655:2017 measurement condition M2
Illuminants	D50/D65/A/F1/F2/F3/F7/F8/F9/F10/F11/F12
Observers	2°/10°
ΔE Methods	ΔE 2000 /ΔE 1994 (Graphic Arts) /ΔE1994 (Textiles) /ΔE 1976
Calibration	White reference built in the sensor cover
Scan Length	400mm
Inter-Instrument Agreement	0.4 or less ΔE00 average 1.0 or less ΔE00 maximum <ul style="list-style-type: none"> Deviation from SD-10 manufacturing standard for 12 BCRA colour tiles (D50, 2°) Ambient temperature 23°C (73.4°F), humidity 50%
Short Term Repeatability	0.1 ΔE94 White <ul style="list-style-type: none"> Average of 10 measurements every 3 seconds on white tile (D50, 2°) Ambient temperature 23°C (73.4°F), humidity 50%
Colour difference from BCRA tile	Calibration value 1.0 or less Δ E00 average <ul style="list-style-type: none"> Deviation from the colour measurement value for 12 BCRA colour tiles (D50, 2°) by a measuring instrument traceable to the national metrological standard Ambient temperature 23°C (73.4°F), humidity 50%
LANGUAGE	
Supported Language	English / French / German / Dutch / Italian / Spanish / Portuguese / Turkish / Russian / Simplified Chinese / Traditional Chinese / Korean / Japanese
CONNECTIVITY	
Interfaces	<ul style="list-style-type: none"> USB Type-C USB 2.0 Full-Speed BLE Bluetooth Low Energy
Memory	Number of saved data at Stand-alone (Spot Mode): 100 Colours
ENVIRONMENT CHARACTERISTICS	
Temperature (°C)	Operating: 0 °C – 40 °C (Spot Mode) / 0 °C – 35 °C (Scan Mode) Storage: -20 °C – 60 °C
Humidity	Operating: 5 – 85% (No Condensation) Storage: 5 – 85% (No Condensation)
DIMENSIONS & WEIGHT	
Shutter Closed (W x D x H)	35 x 80 x 80 mm
Shutter Opened (W x D x H)	35 x 80 x 77.6 mm
Weight	Approx. 190g
ELECTRICAL SPECIFICATION	
Voltage	AC 220 – 240V
Power Consumption	Operating: 5V
BATTERY SPECIFICATION	
Battery Type	Lithium ion battery
Battery Capacity	1,860mAh
SYSTEM	
Compatible Epson Software	Epson Edge Print Pro / Epson Spectrometer App

PRODUCT DIMENSION



WHAT'S IN THE BOX

- Set Up Guide*
- Storage case
- Strap
- USB Type A to C cable
- Certificate of calibration

* PDF user guide is provided on the web/CD-ROM of Open-Source software license document.

©2021 Epson Singapore Pte Ltd. All Rights Reserved. Reproduction in part or in whole, without the written permission from Epson, is strictly prohibited.

EPSON and EXCEED YOUR VISION are registered trademarks of Seiko Epson Corporation.

All other product names and other company names used herein are for identification purposes only and are the trademarks or registered trademarks of their respective owners.

Epson disclaims any and all rights in those marks. Projected images shown herein are simulations. The actual product design and contents may vary. Specifications are subject to change without notice and may vary between countries. Please check with local Epson offices for more information.

Apple, iPad and iPhone are trademarks of Apple Inc., registered in the U.S. and other countries. App Store is a service mark of Apple Inc.

Android is a trademark of Google Inc.

Dealer's Stamp

Information correct at time of printing.
Printed December 2021

DIGITAL COLOUR SPECTROPHOTOMETER SD-10

EPSON
EXCEED YOUR VISION

PORTABLE AND ACCURATE COLOUR MANAGEMENT TOOL.



Improve your printing workflow with Epson's first portable spectrophotometer.

Going digital with colour management is now easier than ever with the SD-10, Epson's first portable colour spectrophotometer. Businesses can save precious time on printing workflow with colour-matching acceleration and a user-friendly colour management system. With the lightweight device, you can easily and quickly compare colours, measure colour values, and reproduce the colour. Eliminate the hassle of analogue colour matching today!

Find the details at www.epson.com.sg



Epson Spectrometer App

Epson (Thailand) Co.,Ltd.
1 Empire Tower, 42nd Floor
South Sathorn Road, Yan Nawa, Sathon, Bangkok 10120

Contact Us
✉ : support@eth.epson.co.th
📍 : Epson Thailand
☎ : 02-460-9699

Follow Us
EpsonThailand

More Details
Website Product Today Virtual Solution Center

Great Portability

At just 190g with an LCD and built-in battery, you can use the SD-10 anywhere, anytime.

Epson Spectrometer App

Connect to your smart devices seamlessly using the exclusive mobile app.

Hassle-free Operation

Operate the SD-10 as a standalone, going PC-less and cable-less while on the go.

DIGITAL COLOUR SPECTROPHOTOMETER SD-10

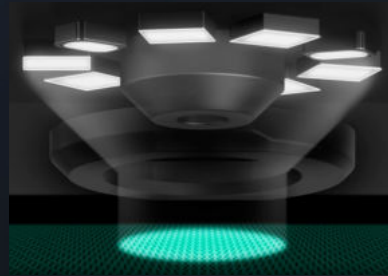

Marrying portability with precision in colour matching, the Epson SD-10 spectrophotometer measures colours with high accuracy while on the go with high reliability. Engineered to ensure the ease of colour management, the SD-10 is especially useful for designers and businesses in the printing and art industry where it is essential to have highly accurate colour matching on the prints.

Improved Colour Matching Workflow

Eliminate the time-intensive process of colour matching in an analogue workflow by going digital with SD-10. Instead of going through multiple visual checking and data adjusting, let Epson's spectrophotometer do the spot colour matching and reproduce exact colours, helping your business save on valuable time and costly manpower.

Manual Colour matching workflow by traditional colour swatches.

Averagely repeat this process up to **4 - 5** times.



- Step 1** Receiving the printing data from client.
- Step 2** Printing out the data to media customer requested by printer.
- Step 3** Comparing the printed colour with colour chart by visual judgement.
- Step 4** Input of colour values to softwares.
- Step 5** Printing out the adjusted data and confirming accuracy visually. Completing the colour matching.
- Step 6** Completing the colour matching.

Digital Colour matching workflow by SD-10.

Averagely repeat this process up to **1 - 2** times.



- Step 1** Receiving the printing data from client.
- Step 2** Measuring the targeted colour using SD-10.
- Step 3** Alternatively, perform spot colour matching method using the Epson Edge Print Pro.
- Step 4** Print out the adjusted image.
- Step 5** Check for accuracy again using SD-10 and complete the workflow.
- Step 6** If necessary, compare using the colour charts for higher accuracy.



*Only solid colour part can be replaced using the function of spot color matching in Epson Edge Print Pro.

Hassle-Free Operation

Lightweight & Portable

The compact SD-10 weighs only 190g and is highly portable with its own carrying case and wrist strap.

Network-free & PC-less Operation

Operate the SD-10 as a stand-alone unit without needing a PC or connecting to any network. The spectrophotometer is equipped with a LCD display and built-in battery for lasting operation, and is easily chargeable via USB Type C cable.



Flexible Connectivity

Epson Spectrometer App

Connect to the mobile application via Bluetooth to store the colour data and for easy reference in the future.

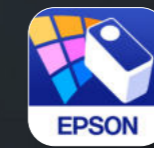

*1 SD-10 connects to smartphone via Bluetooth.

Works with Epson Edge Print Pro

Using USB Type C^{**2} or via Bluetooth^{**3}, you can easily connect to Epson Edge Print Pro to facilitate designing and printing process.

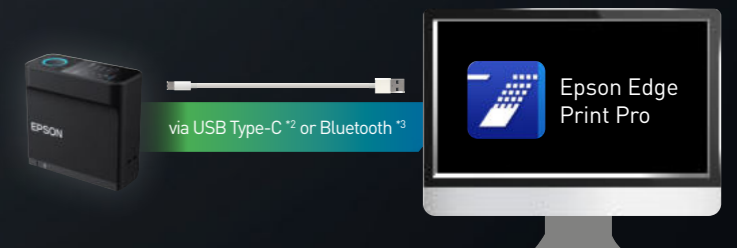

**2 SD-10 can connect to PC via USB-C cable. **3 Requires Epson Edge Print Ver. 4.1 or later.

Intuitive Digital Design

Graphical Information

Get all the colour-related information including the measurement figures and similar colours via the SD-10 app in both graphics and text. With gamut in/out profile, businesses can know immediately if the identified colour is printable or not.

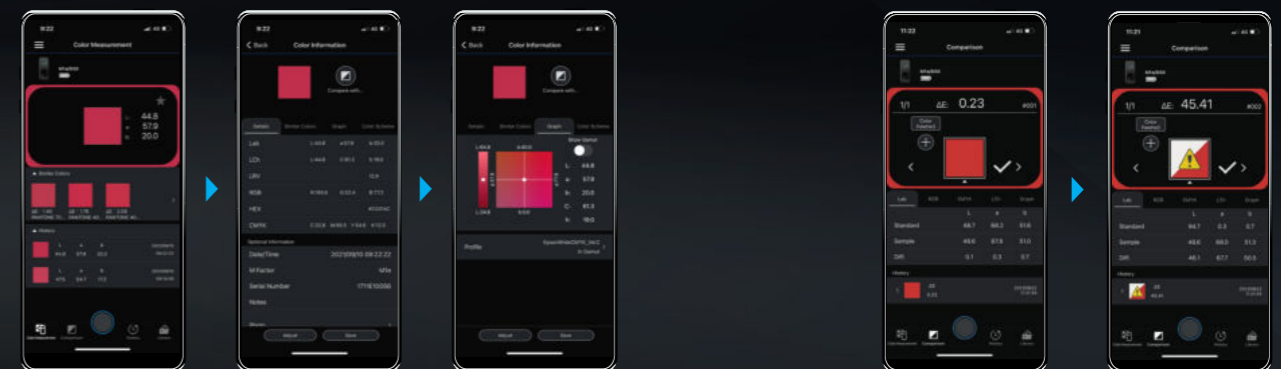

Display Measurement Figures [L*a*b, L*C*h, LRV (Light Reflectance Value), HEX (sRGB), RGB & CMYK]
Graph Display (Gamut outer line, display gamut in/out)

Single Colour Comparison
Multi Colour Comparison