



ALL-ROUNDED, QUALITY LABEL PRINTING SOLUTIONS ON THE GO.

Epson LW-1000P offers convenient and ease-of-use label printing solutions. Increase your productivity with its network-sharing and wireless capabilities that let you print high-quality labels conveniently from your smart devices. Together with its compact design and a built-in automatic round corner cutter, the LW-1000P is the ideal label printer for any business environments.

- Wi-Fi
- Ethernet
- Auto-cutter
- Humidity Resistant Tapes
- Scratch Resistant Tapes
- Temperature Resistant Tapes
- Water Resistant Tapes



IT'S IN THE DETAILS.

Multiple Network Connectivity

Wi-Fi and Ethernet network connectivity available. Connect up to 4 devices simultaneously with the printer as Simple Access Point mode.

Smart Label Printing

Easily create, edit, share and print quality labels effortlessly with Epson softwares and applications, from PC or smart devices.

Superior Print Speed and Performance

Save time while getting more done with a blazing print speed of up to 35mm/second.

Whether in an office or warehouse environment, the LW-1000P gives you the most versatile solutions for every labelling need. Take productivity to a new level with its seamless Wi-Fi and Ethernet capabilities that enable wireless label printing conveniently from your smart devices.



Multiple Network-sharing Capabilities

The Epson LW-1000P enables easy sharing capabilities that allow users to connect directly to the printer from anywhere within the same network. With seamless Wi-Fi and Ethernet connectivity, label printing becomes more cost-efficient and you only need one printer to serve all users in your work group.

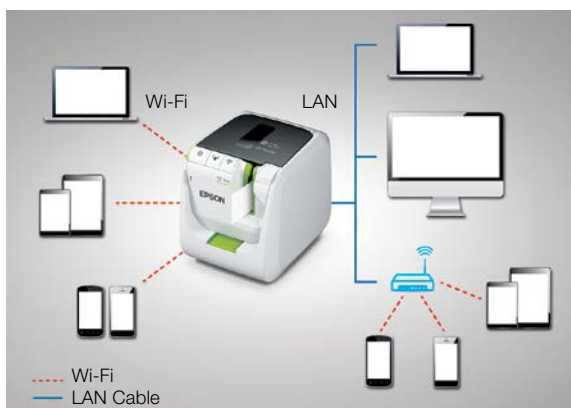

Ultimate Versatility with Epson Label Editor

The Epson LW-1000P is compatible with Epson Label Editor software for more customisable experience. The software comes with more than 70 pre-installed templates to create custom labels and also allows for more customisation of labels with its functionality to import images and barcodes.

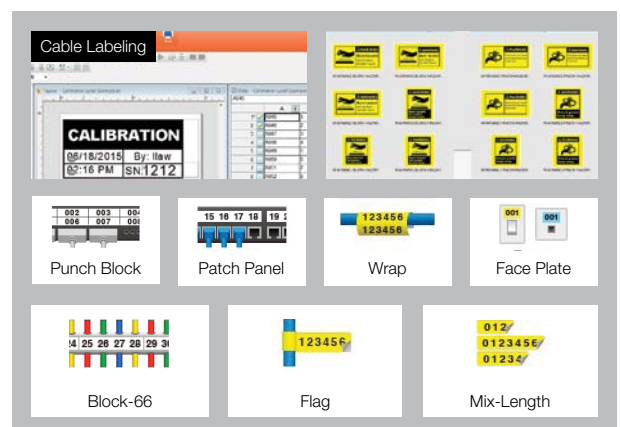

Superior Print Speed and Performance

Reduce waiting time and increase productivity with the LW-1000P, the fastest label maker in Epson's LabelWorks range. Quality label printing has never been this quick and efficient, now with a stunning print speed of up to 35mm/second and an impressive resolution of 360dpi that produces crisp and clear labels for a wide range of applications.

Easy Installation of Tape Cartridges

Designed for ease of use, Epson LW-1000P features a handy top-loading tape feed for fuss-free refills. Boost your productivity with this simple drop-in and snap-on installation without any mess.



Create Round-corner Labels with Ease

Create great looking labels effortlessly each time you print. Printing on a range of widths of up to 36mm, Epson LW-1000P comes with an exclusive integrated trim cutter that creates round label edges conveniently, making your labels more durable and far less likely to peel off.

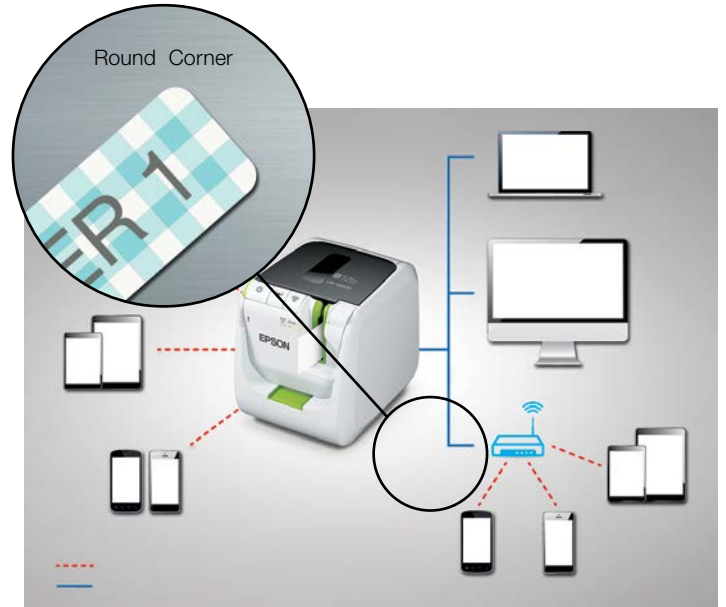

Versatile Range of Media and Styles

The LW-1000P offers tremendous creative flexibility with the Epson Label Editor that comes with a full range of font types available on your PC or Mac operating system. This software also lets you add images and company logos on the labels for a unique and professional look.



Be spoilt for choice with Epson's wide selection of high-quality labels in a variety of styles, sizes and colours. Tape widths range from 6mm to 36mm, in standard, metallic and pastel colours, patterns, and even specialised applications such as iron-on, ribbon or cable wrap.

Economical, Longer-lasting Labels

Epson labels can withstand exposure to heat, cold and wet conditions, making them ideal for any application in offices through tough industrial environments.

The LW-1000P is designed from the ground up for greater cost efficiency, using significantly smaller lead margin to reduce wastage.

- Print more labels with LK tape length of up to 9 meters per cartridge
- Durable labels that can survive extreme conditions
- Sticks fast to curved, glass and stainless steel surfaces
- No residue from adhesive when labels are removed



MODEL NUMBER	LW-1000P
Printing	
Technology	Thermal transfer
Tape Width	9, 12, 18, 24, 36 mm
Resolution	360 dpi
Printable Dot Numbers	384
Max. Print Height	27.1mm
Max. Print Speed	35mm / sec
Print Settings	
Repeat Printing	Yes
Auto Increment	Yes
Mirror Printing	Yes
Vertical Printing	Yes
Margin Setting	Manual / Auto
Fixed Length	Auto / Custom
Setting Area	Yes
Wire Wrap	Yes
Flag	Yes
QR Code	Yes
Barcodes	14 types (via Label Editor software) (EAN-8 / EAN13 / CODE39 / CODE128 / UPC-A / UPC-E / CODABAR / ITF / EAN128 / GS1DataBar / QRcode / MaxiCode / PDF417 / Data Matrix)
Fonts and Styles	PC Dependent
Hardware	
Cutter	Auto full cut, half cut, corner trim
Detection	Tape end, tape width, cover open
Power LED	Yes
Connectivity	
Interface	USB, LAN, Wi-Fi
Support OS	Windows, Mac, Android, iOS
Supported Softwares / Apps	Epson Label Editor (for PC), Epson iLabel, Epson Datacom (smart devices)
General	
AC Adaptor	Bundled
Colour	Blueish White / Green

Supplied Accessories

- Power Adapter
- USB Cable
- 1 x 12mm Black on White tape (4m)
- Installation Guide

Dimensions & Weight

LW-1000P

Weight: Approx. 1.08kg (2.38lbs)



© 2018 Epson Singapore Pte Ltd. All Rights Reserved. Reproduction in part or in whole, without the written permission from Epson, is strictly prohibited.

EPSON and EXCEED YOUR VISION are registered trademarks of Seiko Epson Corporation.

All other products names and other company names used herein are for identification purposes only and are the trademarks or registered trademarks of their respective owners.

Epson disclaims any and all rights in those marks. Print samples shown are simulations only. Specifications and product availability are subject to change without notice and may vary between countries. Please check with local Epson offices for more information.

Apple, iPad and iPhone are trademarks of Apple Inc., registered in the U.S. and other countries. App Store is a service mark of Apple Inc.

Android is a trademark of Google Inc.

Information correct as at August 2018