



## Flexibility in Printing to Serve Various Printing Needs

Epson’s superior inkjet printing technology, renowned for its versatility, delivers fuss-free digital Direct-to-fabric printing across a wide range of applications. The Monna Lisa ML-32000U can fulfil a wide variety of production needs, making it an invaluable asset in the textile printing business.



### Haute Couture Fashion

Monna Lisa provides clothing designers from leading Italian and foreign fashion houses with a wealth of colours and shades to create unique items that combine both innovation and artisanry.



### Ready-to-Wear Fashion

Monna Lisa endows the productivity demanded by fashion retailers with its typical quality standards, for collections that are more than just seasonal.



### Fashion Accessories

Natural fabrics and innovative yarn for scarves, ties, shoes or handbags are enriched with traditional motifs and original patterns featuring precision of detail and unparalleled repeatability achievable only with Monna Lisa.



### Home Textiles

Curtains, sofa and armchair fabrics, home linens and contract furnishing fabrics are all produced with different types of yarn. Monna Lisa’s extensive variety of inks produces fabrics embellished with designs and original colours that last through the years.



### Sportswear

Thanks to extensive ink testing, Monna Lisa provides excellent quality even on innovative technical fabrics developed to meet increasingly sophisticated communication and functional needs.

## SPECIFICATIONS

Model Number		ML-32000U		
<b>Print</b>				
Printing Technology	PrecisionCore Inkjet Technology			
Number of Printheads	32			
Number of Colours	8			
Maximum Resolution	1,200 x 1,200 dpi			
Gradation Process	Variable-Sized Droplet Technology			
Maximum Print Width	1,800 mm (71")			
Maximum Print Length	Unlimited			
Maximum Fabric Width	1,800 mm (71") / 2,400 mm (94") / 3,400 mm (133")			
Maximum Fabric Thickness	10.0 mm			
<b>Print Speed</b>				
Square*	Maximum Printing Speed (m <sup>2</sup> /h)	697	(300 x 600 dpi, 1 Pass)	
	Typical Printing Speed 1 (m <sup>2</sup> /h)	423	(600 x 600 dpi, 2 Pass)	
	Typical Printing Speed 2 (m <sup>2</sup> /h)	305	(900 x 600 dpi, 3 Pass)	
	Maximum Printing Speed (sq ft/hr)	7,502	(300 x 600 dpi, 1 Pass)	
	Typical Printing Speed 1 (sq ft/hr)	4,553	(600 x 600 dpi, 2 Pass)	
	Typical Printing Speed 2 (sq ft/hr)	3,283	(900 x 600 dpi, 3 Pass)	
	Linear*	Maximum Printing Speed (lmt/h)	465	(300 x 600 dpi, 1 Pass)
		Typical Printing Speed 1 (lmt/h)	282	(600 x 600 dpi, 2 Pass)
		Typical Printing Speed 2 (lmt/h)	203	(900 x 600 dpi, 3 Pass)
		Maximum Printing Speed (li ft/hr)	1,524	(300 x 600 dpi, 1 Pass)
Typical Printing Speed 1 (li ft/hr)		925	(600 x 600 dpi, 2 Pass)	
Typical Printing Speed 2 (li ft/hr)		667	(900 x 600 dpi, 3 Pass)	
<b>Fabric Handling</b>				
Fabric Drive	Conveyor Belt with Adhesive			
Belt Washing	Automatic			
<b>Dimensions</b>				
Printer (W x D x H)	ML-32000U: 4,610 x 2,500 x 2,070 mm / 181 x 98 x 81 inch ML-32000U-240: 5,260 x 2,500 x 1,940 mm / 207 x 98 x 76 inch ML-32000U-340: 6,560 x 2,500 x 1,940 mm / 258 x 98 x 76 inch			
Control Box (W x D x H)	ML-32000U: 660 x 1,500 x 2,290 mm / 26 x 59 x 90 inch ML-32000U-240 / ML-32000U-340: 620 x 1,410 x 2,290 mm / 24 x 56 x 90 inch			
<b>Weight</b>				
Printer	ML-32000U: Approx. 3,900 kg (8,598 lb) ML-32000U-240: Approx. 4,300 kg (9,480 lb) ML-32000U-340: Approx 6,000 kg (13,228 lb)			
Control Box	Approx. 400 kg (882 lb)			
Ink Rack	Approx. 240 kg (529 lb) (excluding ink)			
<b>Environmental Characteristics</b>				
Temperature (°C)	Operating: 20 °C – 30 °C (68 °F – 86 °F) Recommended: 22 °C – 28 °C (72 °F – 82 °F) Operating: 40 – 60% RH (no condensation)			
Humidity				
<b>Electrical Specification</b>				
Voltage	Main Unit: 400V, 3 phase + Neutral + Earth			
Frequency	50/60 Hz			
Power Consumption	Operating: 20.7kVA			
<b>Certifications**</b>				
Safety / Electromagnetic	Brazil: NR12 EU, EFTA Countries, Turkey, UK: Machinery Directive, EMC Directive (CE/UKCA) Morocco: Safety & EMC regulation (CP) Australia, New Zealand: Australia EMC framework (RCM) Korea: MSIP regulation (KC)			
<b>Network</b>				
Transmission Speed	100 BASE-TX or more (recommended)			

\* Printing width: 1500mm, Printing mode: bidirectional. Printing speeds vary depending on such factors as image printed, firmware version, operating state of PC and print settings.  
\*\* Please contact Epson for the specifications of ML-32000U-240 / ML-32000U-340.

Find out more at [www.epson.com.sg/gobig-direct-to-fabric](http://www.epson.com.sg/gobig-direct-to-fabric)

EpsonSingapore EpsonSingapore EpsonSoutheastAsia Epson Singapore EpsonSingapore

**Epson Singapore Pte Ltd** 438B Alexandra Road, Block B Alexandra Technopark, #04-01/04, Singapore 119968. Tel: (65) 6586-5500  
**Epson Authorised Service Centre** 6 Harper Road, #04-01 Leong Huat Building, Singapore 369674. Epson Helpdesk: 800-120-5564. Please refer to [www.epson.com.sg/contact](http://www.epson.com.sg/contact) for opening hours.

## Working Area

### Dimensions of ML-32000U

Width: 8,110 mm  
Height: 2,290 mm  
Depth: 5,400 mm



## GENESTA INK

### Acid

Black, Cyan, Magenta, Yellow, Grey, Red, Blue, Cobalt, Orange, Rubine, Fluorescent Pink, Fluorescent Flavine, ACROSS (Ink penetration liquid)

### Reactive

Black, Cyan, Magenta, Yellow, Grey, Red, Blue, Orange, Crimson, ACROSS (Ink penetration liquid)

### Disperse

Black, Cyan, Magenta, Yellow, Grey, Red, Blue, Orange, ACROSS (Ink penetration liquid)

### Pigment

Black, Cyan, Magenta, Yellow, Grey, Red, Green, Orange

### Ink Capacity

10 litres

©2025 Epson Singapore Pte Ltd. All Rights Reserved.  
Reproduction in part or in whole, without the written permission from Epson, is strictly prohibited.  
EPSON is a registered trademark of Seiko Epson Corporation.

All other product and company names used herein are for identification purposes only and are the trademarks or registered trademarks of their respective owners.  
Epson disclaims any and all rights in those marks.  
Projected images shown herein are simulations.  
The actual product design and contents may vary.  
Specifications are subject to change without notice and may vary between countries. Please check with local Epson offices for more information.

Dealer's Stamp

Information correct at time of printing.  
Printed July 2025

## DIRECT-TO-FABRIC DIGITAL TEXTILE PRINTER MONNA LISA ML-32000U

# EPSON



## Next-level digital textile printing engineered for industrial productivity and exceptional print precision.

Designed with high-quality print and productivity in mind, Monna Lisa ML-32000U is businesses’ answer to the industrial, high production textile printing. Together with Epson’s Total Textile Solution, the versatile ML-32000U can adapt to a wide range of applications, making it ideal for Direct-to-Fabric printing and ensuring customer satisfaction. Equipped with 32 PrecisionCore MicroTFP printheads, the ML-32000U delivers the highest colour consistency and finest details with Epson’s eco-friendly GENESTA inks.

## ENGINEERED FOR good

### Superb Quality & Efficiency

Reaching a print speed of 697 square metres per hour, the ML-32000U delivers impeccable prints with superb efficiency for high production digital textile printing.

### Stable & Reliable Operations

Ensuring uninterrupted, high-precision printing with intelligent head-strike prevention, accurate dot placement, and continuous ink supply for stable, efficient production.

### Extensive Software Compatibility

The ML-32000U supports Epson Edge Print PRO X, a specially designed RIP software with an intuitive interface for the Monna Lisa series, along with other RIPs and textile CADs.





DIRECT-TO-FABRIC DIGITAL TEXTILE PRINTER  
MONNA LISA ML-32000U

Designed for excellent print quality at high efficiency, Monna Lisa ML-32000U encompasses the brand’s industry-leading expertise in ink and printhead development, image processing, and pre- and post-fabric treatment. Equipped with 32 PrecisionCore MicroTFP printheads, the ML-32000U delivers robust prints at high speeds to support your business in meeting the needs of a highly competitive textile market.

Superb Print Quality and Efficiency

Epson Precision Dot Technology  
For World-Renowned Image

Epson Precision Dot technology, refined over many years of inkjet printer development, underlines the ML-32000U’s superior image quality. In addition, our exclusive Micro Weave, Multi-Layer Halftoning, and LUT technologies work together to reduce banding, graininess, and image quality degradation caused by dot placement errors.

Dynamic Alignment Stabiliser (DAS)  
Techonology For Uniform Dot Density

Boosting an effective print speed of 697 square metres per hour [300 x 600dpi, 1 pass], the ML-32000U is equipped with Dynamic Alignment Stabiliser technology, which ensures stable print quality by controlling waveforms on each printhead chip to achieve higher dot placement accuracy and more uniform dot density on each pass.

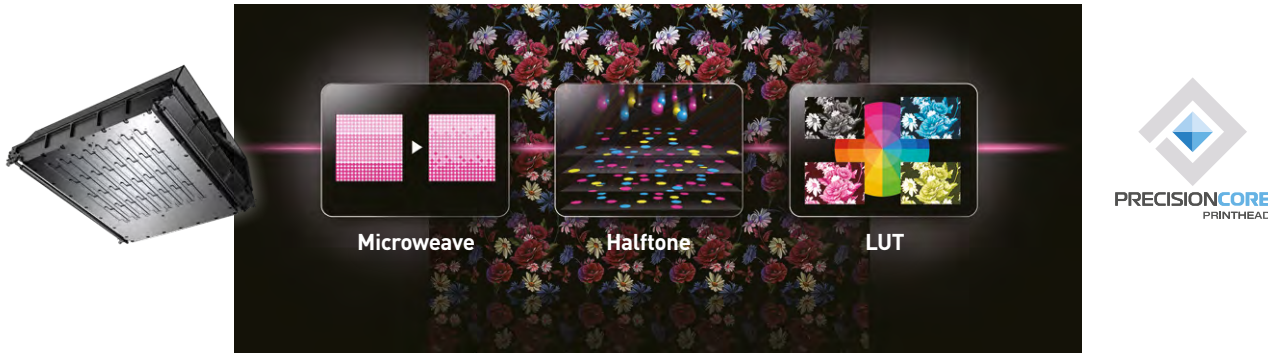

Accurate Belt Position Control (ABPC)  
Technology For High-Precision Fabric Feeding

High image quality requires precise fabric feeding. The ML-32000U achieves this with new Accurate Belt Position Control (ABPC) technology that automatically detects belt feeding distance to ensure highly accurate fabric feeding.

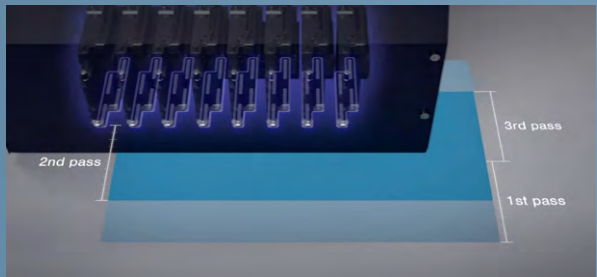

Symmetrical Colour Alignment  
For High Bidirectional Printing Quality

Symmetrical colour alignment maintains consistent colour overlap order during high-speed bidirectional low-pass printing for uniform image quality.

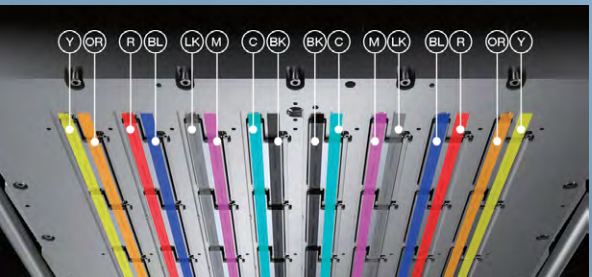

Stable and Reliable Operation

Dual Sensor System  
To Prevent Costly Head Strikes

Dual head-strike sensors detect any folds or wrinkles that may cause the fabric to come into direct contact with the printheads. If folds or wrinkles are detected, the sensors immediately stop the carriage to avert a potential head strike.

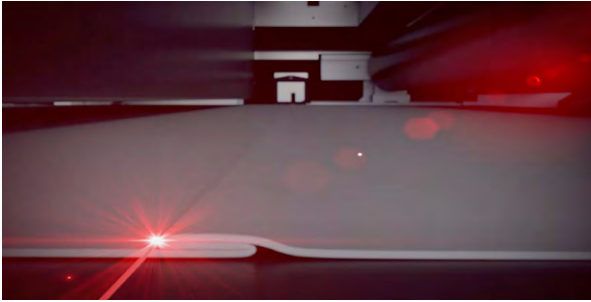

High-Accuracy Head Alignment Technology  
For Highly Accurate Dot Placement

High-precision positioning pins and holes on the printhead and carriage enable accurate dot placement for high print quality.



High-Capacity Ink Supply For Uninterrupted Production

Large capacity vacuum-packed degassed ink cartridges can be loaded for each colour, and you don’t need to worry about running out of ink halfway through a job because empty cartridges can be replaced while printing is in progress.

32  
PrecisionCore  
MicroTFP printheads

697m<sup>2</sup>/h  
Max. printing speed  
[300 x 600dpi, 1 pass]



User-friendly Ink Management  
with GENESTA Inks

Environmentally-Conscious Printing

Epson GENESTA inks are available in Acid, Reactive, Disperse, and Pigment formulations. They are ECO PASSPORT certificated to meet globally recognised standards for environmentally friendly textile printing. In addition, our Acid ink is bluesign® approved, and our Reactive, Acid and Pigment inks are GOTS approved by ECOCERT\*.

\*Genesta RE-N Reactive inks: except one of Grey (Grey RE-N), Genesta AC Acid inks: except Black AC-N / Grey AC-N.



Flexibility With 8+8 Colour Channel Configurations

The ML-32000U offers a choice of colour channel configurations to suit your production needs. The 8+8 colour configuration can be loaded with two different types of ink simultaneously (e.g., Acid +Reactive) to increase the fabric types that can be printed, and is of particular value when working with limited space or a tight budget.

Epson Edge Print Textile (RIP software)

Epson’s original RIP software, Epson Edge Print PRO X, has an intuitive interface for an easy 3-step left-to-right operation, as well as step and repeat, hot folders, colour replacement for matching spot colours, and other convenient features. The optional ColorBlend pre-processing software also lets you create colour variations (Colorways), control ink penetration, generate ICC profiles and perform other pre-processing tasks.

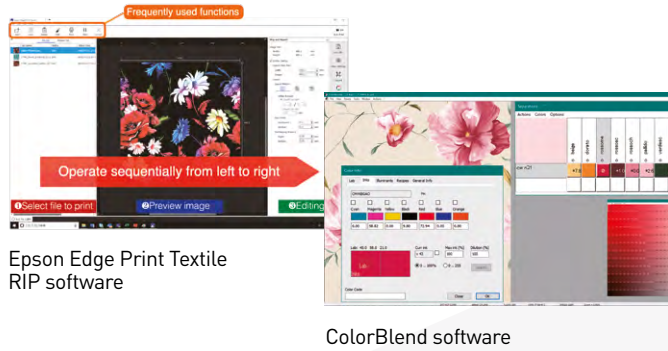

Epson Digital Total Textile Solution

The fully integrated system for industrial digital printing on textiles, Epson’s Total Solution delivers the best printing results with maximum productivity on your ML-32000U.

With all components belonging to the same process, the best printing result is guaranteed with utmost customer satisfaction.

